

1		2	
P1			P2
PIN NO#	FUNCTION	COLOR	PIN NO#
1	SMBus VCC	RED(紅)	TIN
2	SMBus SDA	GREEN(綠)	TIN
3	SMBus SCL	WHITE(白)	TIN
4	GPI01	BLUE(藍)	TIN
5	GPI02	ORANGE(橙)	TIN
6	GND	BLACK(黑)	TIN

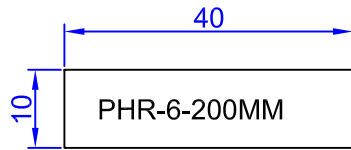

LABEL

RFQ Date		2020/03/02	
Project Name		TEXIM EUROPE	
CPU Board			
LCD			
Revision	Changed Records		Date
1.0	FIRST VERSION		2020/03/03

Distributed by:

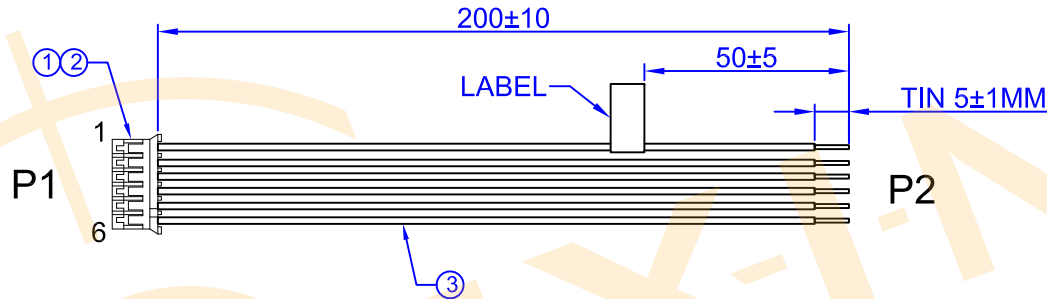

RoHS 3.0 Compliant

NOTE:
ELECTRICAL TEST:
(1) 100% OPEN, SHORT, MIS-WIRE
(2) CONTACT RESISTANCE: 3Ω MAX.
(3) INSULATION RESISTANCE: 10MΩ MIN
(4) CONTACT VOLTAGE: DC 300V

3	WIRE	UL1007 24#	6PCS
2	TERMINAL	2012P OR EQU	6PCS
1	HOUSING	2020H-06P (PHR) 2.0PITCH OR EQU	1PC
ITEM	PART	SPEC	Q'TY

CUSTOMER		Texim Europe b.v.			
PART NUMBER		PHR-6-200MM			
DESCRIPTION		200mm user interface for RRC PMM240			
REV	1.0	DATE	2020/03/10	PAGE	1/1
VIEW		CREATE BY		THOMAS	

Disclaimer

ALL PRODUCTS, PRODUCT SPECIFICATIONS AND DATA ARE SUBJECT TO CHANGE WITHOUT NOTICE TO IMPROVE RELIABILITY, FUNCTION OR DESIGN OR OTHERWISE.

Texim Europe B.V. its affiliates, agents, and employees, and all persons acting on its or their behalf (collectively, “Texim”), disclaim any and all liability for any errors, inaccuracies or incompleteness contained in any datasheet or in any other disclosure relating to any product.

Texim makes no warranty, representation or guarantee regarding the suitability of the products for any particular purpose or the continuing production of any product.

It is the customer’s responsibility to validate that a particular product with the properties described in the product specification is suitable for use in a particular application.

Parameters provided in datasheets and / or specifications may vary in different applications and performance may vary over time.

All operating parameters, including typical parameters, must be validated for each customer application by the customer’s technical experts.

Please contact us if you have any questions about the contents of the datasheet.

This may not be the latest version of the datasheet. Please check with us if a later version is available.



Headquarters & Warehouse

Elektrostraat 17
NL-7483 PG Haaksbergen
The Netherlands

T: +31 (0)53 573 33 33
E: info@texim-europe.com
Homepage: www.texim-europe.com



The Netherlands

Elektrostraat 17
NL-7483 PG Haaksbergen

T: +31 (0)53 573 33 33
E: nl@texim-europe.com



Belgium

Zuiderlaan 14, box 10
B-1731 Zellik

T: +32 (0)2 462 01 00
E: belgium@texim-europe.com



UK & Ireland

St Mary's House, Church Lane
Carlton Le Moorland
Lincoln LN5 9HS

T: +44 (0)1522 789 555
E: uk@texim-europe.com



Germany - North

Bahnhofstrasse 92
D-25451 Quickborn

T: +49 (0)4106 627 07-0
E: germany@texim-europe.com



Germany - South

Martin-Kollar-Strasse 9
D-81829 München

T: +49 (0)89 436 086-0
E: muenchen@texim-europe.com



Austria

Warwitzstrasse 9
A-5020 Salzburg

T: +43 (0)662 216 026
E: austria@texim-europe.com



Nordic

Stockholmsgade 45
2100 Copenhagen

T: +45 88 20 26 30
E: nordic@texim-europe.com



Italy

Martin-Kollar-Strasse 9
D-81829 München

T: +49 (0)89 436 086-0
E: italy@texim-europe.com